

PURILAN LUMINO

Installation instructions

Montagehandleiding

Notice de montage

Montageanleitung

Istruzioni di montaggio



ubbink

Build smart.

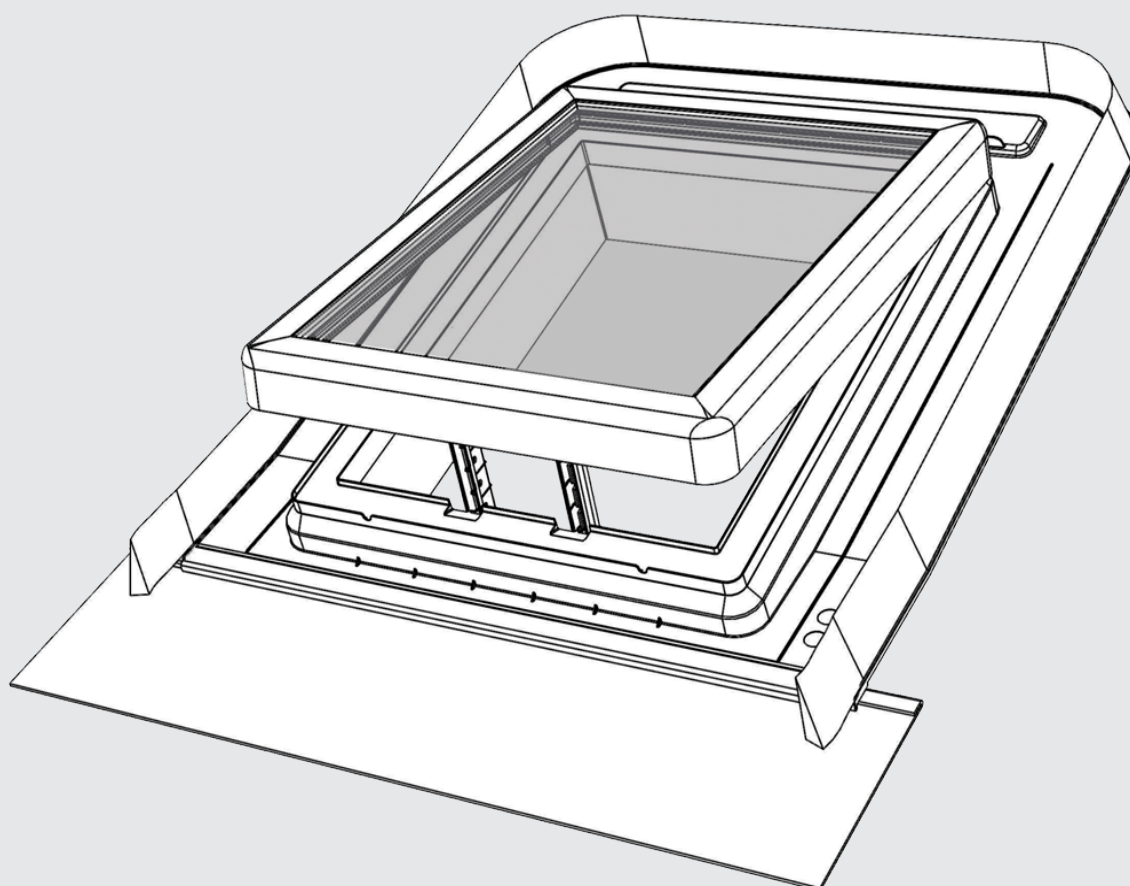

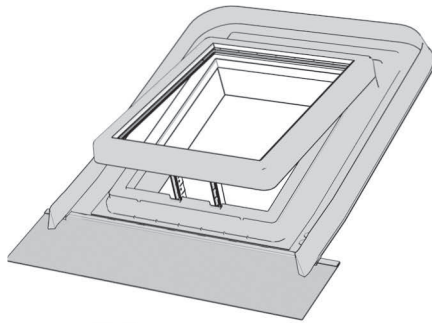

EN Contents **FR** Contenu **IT** Indice

NL Inhoud **DE** Inhalt



EN Tools required

NL Benodigde gereedschappen

FR Outils nécessaires

DE Benötigte Werkzeuge

IT Attrezzi necessari

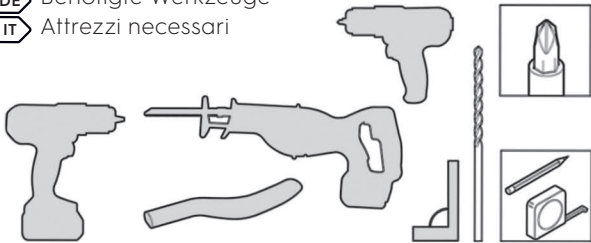

EN Take all necessary precautions to prevent personal injury.

NL Neem al de benodigde voorzorgsmaatregelen ter voorkoming van persoonlijk letsel.

FR Prenez toutes les précautions nécessaires pour éviter tout risque de blessure.

DE Treffen Sie alle erforderlichen Vorsichtsmaßnahmen, um Verletzungen zu vermeiden.

IT Adottare tutte le misure di sicurezza necessarie per prevenire lesioni personali.

EN To finish the inside of the roof boarding, use the Lumino plano edge, including the interior finishing edge.

NL Gebruik voor de afwerking van de binnenkant van het dakbeshot de Lumino plano rand inclusief interieur afwerkrand.

FR Pour la finition de la face intérieure du revêtement de toiture, utilisez la bordure Lumino plano, y compris la bordure de finition intérieure.

DE Verwenden Sie für die Verkleidung der Innenseite der Dachschalung die Lumino Plano-Leiste inklusive Innenverkleidungsleiste.

IT Per la finitura interna del rivestimento del tetto, utilizzare il profilo Lumino plano con bordo di finitura per interni incluso.

X =

EN Roof panel thickness including battens and roof battens

NL Dakplaatdikte inclusief tengel en panlat

FR Épaisseur de la toiture, lattes et solin compris.

DE Dachplattenstärke einschließlich Dachlatte und Dachschalung

IT Spessore della lastra del tetto, comprese la lamiera di raccordo e la listella

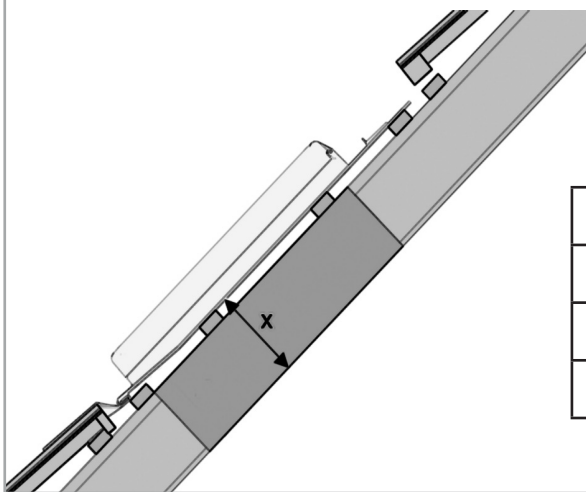

Type	Art.nr.	x
Lumino 300	100000350320	< 245 mm
Lumino 400	100000350321	< 345 mm
Lumino 500	100000350322	< 445 mm

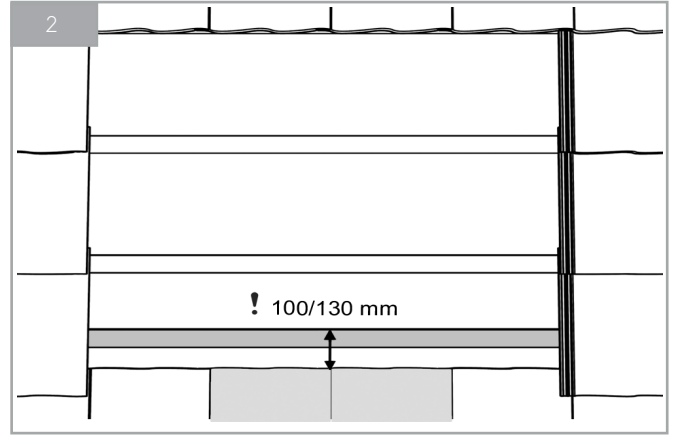
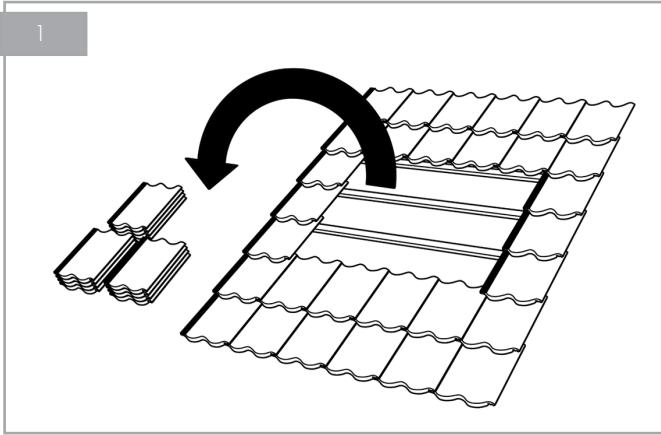

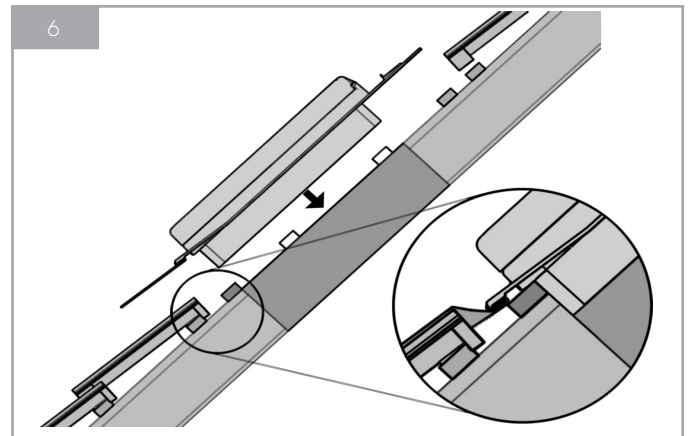
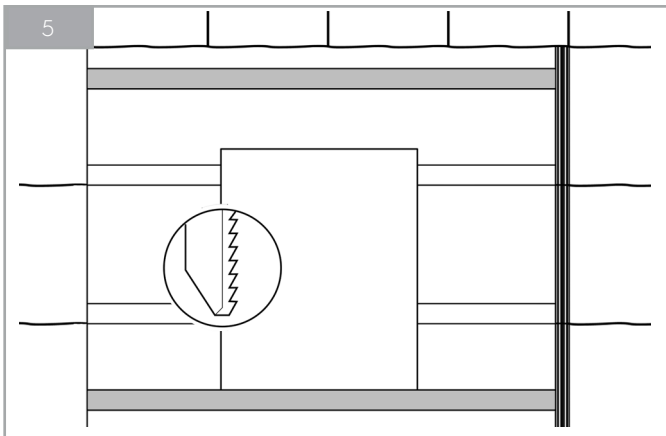
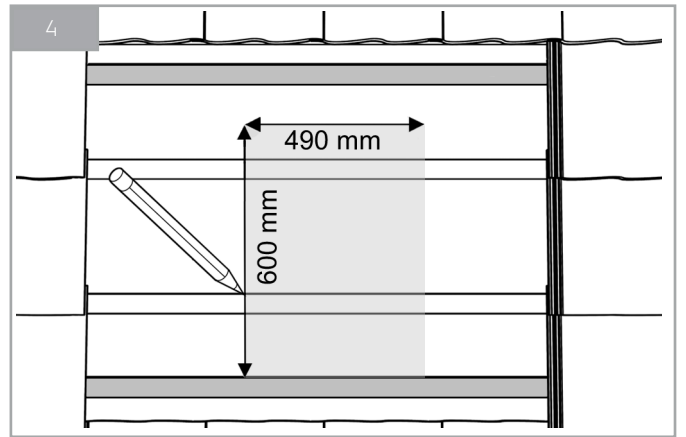
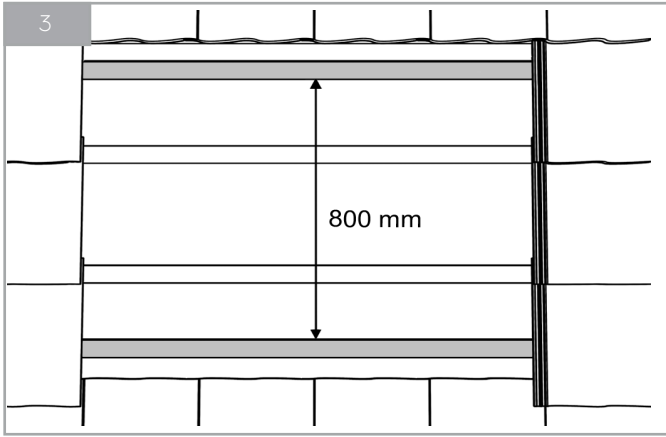

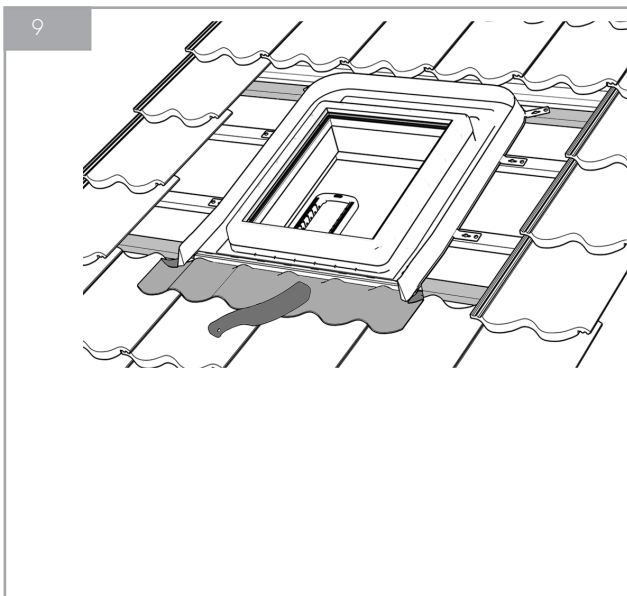
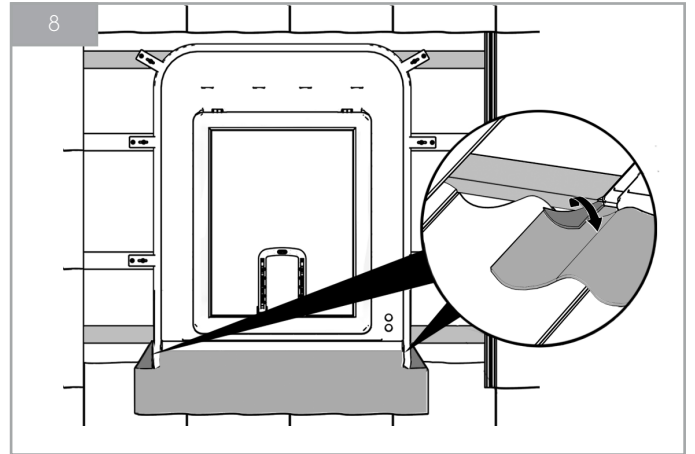
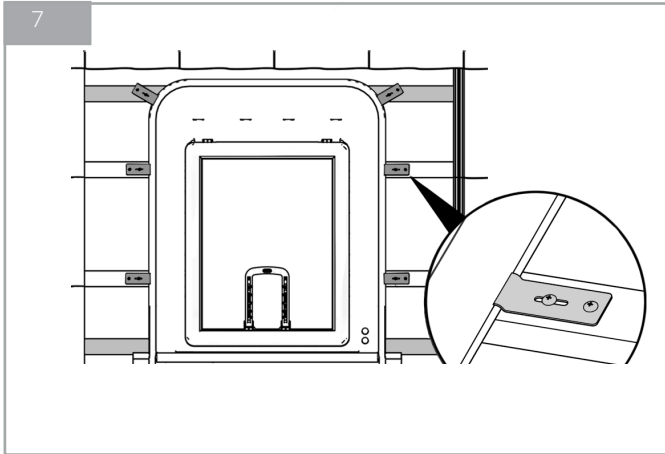

- EN Follow the Ubiflex application instructions
- NL Klop Ubiflex conform verwerkingsvoorschriften
- FR Positionner Ubiflex conformément aux instructions d'utilisation
- DE Ubiflex gemäß den Verarbeitungsanweisungen aufschlagen
- IT Seguire le istruzioni di utilizzo di Ubiflex

10

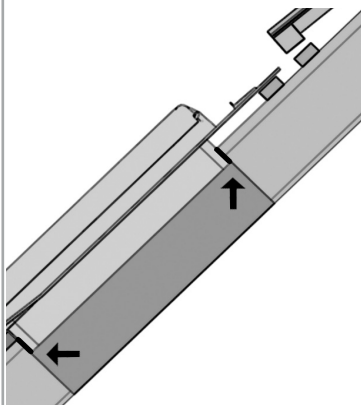

- EN** Use Compriband for the seal. Place this around the insulation sections. Do **not use** PUR foam for the seal.
- NL** Gebruik compriband voor de afdichting. Plaats dit rondom de isolatiedelen. Gebruik **geen** PUR-schuim voor de afdichting.
- FR** Utilisez du Compriband pour l'étanchéité. Placez-le autour des sections d'isolation. N'utilisez pas de mousse **PUR** pour l'étanchéité.
- DE** DE: Verwenden Sie Compriband zur Abdichtung. Bringen Sie dieses rund um die Dämmteile an. Verwenden **Sie keinen** PUR-Schaum zur Abdichtung.
- IT** Utilizzare del nastro sigillante per la sigillatura. Applicarlo attorno agli elementi isolanti. **Non utilizzare** schiuma PUR per la sigillatura.

11

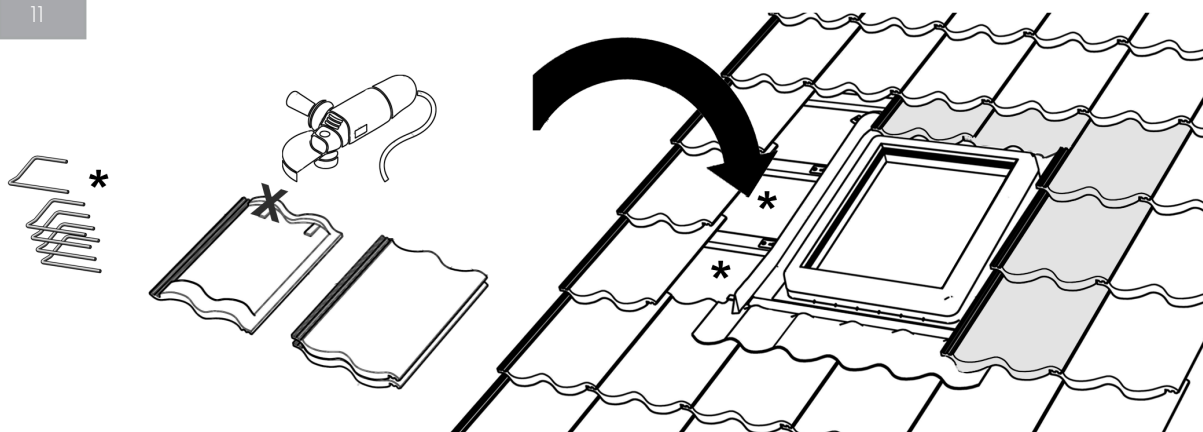



ENERGY



VENTILATION



BUILDING

Nederland • 📞 +31 313 480-300 • 🌐 productadvieslijn@ubbink.nl

France • 📞 +33 (0)2 51 13 46 46 • 🌐 ubbink@ubbink.fr

Belgium • 📞 +32 9 237 11 00 • 🌐 info.bouw@ubbink.be

United Kingdom • 📞 +44 1604 433-000 • 🌐 info@ubbink.co.uk

Deutschland • 📞 +49 2301 91011-0 • 🌐 info@ubbink.de

Italia • 📞 +39 045 602 0433 • 🌐 info@ubbink.it



Ubbink International

@ info@ubbink.com • 🌐 www.ubbink.com

Copyright © 2026 Ubbink | Content is subject to change without notice; no liability for errors and misprints.
Availability and configurations may differ per country | UB-2026-06-V01

100000072416